







1	DPM400-345	1
2	DPM400-346	1
3	DPM400-356	1
4	DPM400-493	1
5	DPM400-351	1
6	DPM400-360	1
7	DPM400-359	1
8	DPM400-355	1
9	DPM400-117	2
10	DPM400-120	2
11	DPM400-357	2
12	FAM400-354	1
13	DPM400-495	1
14	FAM400-342	2
15	DPM400-494	1
16	DPM400-358	2

PNT 410 M	  		
	M5	DPM400-336	FAM400-171
	M6	DPM400-337	FAM400-173
	M8	DPM400-338	FAM400-176
	M10	DPM400-339	FAM400-178
M12	DPM400-340	FAM400-208	

TK, TL & TH SERIES ONLY

PNT 410 IP	  		
	10-24unc	DPM400-475	FAM400-430
	10-32unf	DPM400-476	FAM400-430
	1/4-20unc	DPM400-477	FAM400-431
	5/16-18unc	DPM400-478	FAM400-432
	3/8-16unc	DPM400-479	FAM400-433
1/2-13unc	DPM400-480	FAM400-434	

Additional nosepieces are available – refer to www.emhart.com

POP Nut™ PNT410

POP®

Heavy Duty Lever Tool

- ES** Remachadora Profesional Tipo Palanca
- PT** Rebitadeira para uso pesado tipo Alavanca
- FR** Pince à leviers pour inserts de grands diamètres
- DE** Hochleistungs-Hebelwerkzeug
- SE** Robust tvåhandsverktyg för medelstor produktion
- DK** Tohåndstang med stor nittekraft – til små og mellemstore produktioner
- FI** Sisäkierreniitti – vipuvarsipihdit – M 12 saakka
- JP** 強力型レバー式ポップナットツール

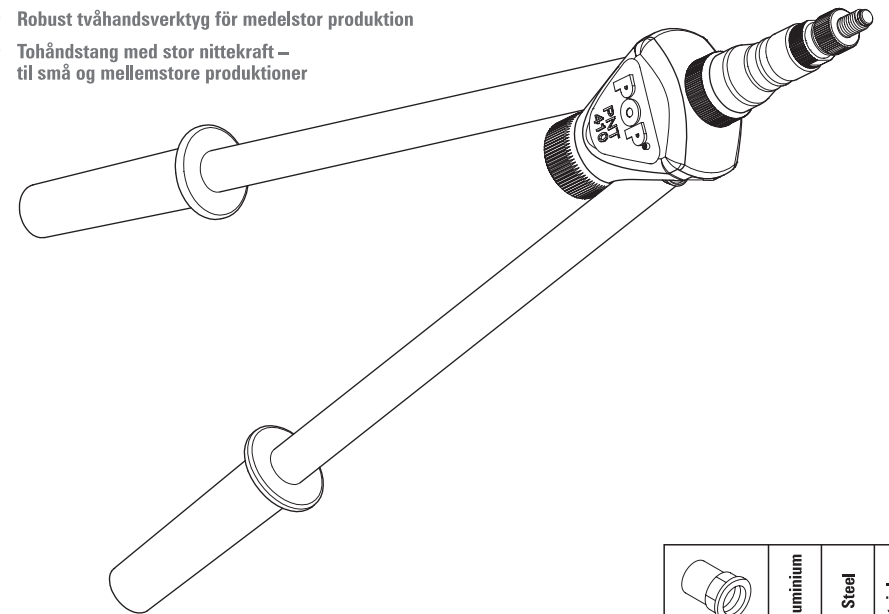

GB Read the Manual

ES Leer el Manual

PT Leia o manual

FR Lire le manuel

DE Lesen Sie die Betriebsanleitung

SE Läs manualen

DK Læs manualen grundigt

FI Kts. huolto-ohjeet

JP 取扱説明書をお読みください。



Wear Safety Goggles

Usar Gafas de Seguridad

Use Óculos de Proteção

Porter des lunettes de protection

Tragen Sie eine Schutzbrille

Använd säkerhetsglasögon (eller glasögon)

Anvend beskyttelsesbriller

Käytä suojasilmälaseja

保護めがねを着用してください。

PNT 410 M				
	M5	Aluminium	Steel	Stainless Steel
	M6	✓	✓	✓
	M8	✓	✓	✓
	M10	✓	✓	✓
M12	✓	✓	✓	

PNT 410 IP				
	10-24unc	✓	✓	✓
	10-32unf	✓	✓	✓
	1/4-20unc	✓	✓	✓
	5/16-18unc	✓	✓	✓
	3/8-16unc	✓	✓	✓
1/2-13unc	✓	✓	✓	

6083/PNT410/1

www.emhart.com

**Emhart
Tecnologies**
POP NUT™

www.emhart.com

NORSTEEL Sp. z o.o. ul. W. Witosa 11a 58-100 Świdnica
E-mail: biuro@norsteel.pl; norbert.zieba@norsteel.pl www.norsteel.pl
Mobile: +48 795-418-405 Tel./ Fax : +48 (074) 850-53-91

**Emhart
Tecnologies**
POP NUT™

